



POWER HOISTMAN CORDLESS DRILL DRIVEN & HAND CRANK HOIST

The Power Hoistman is beneficial for areas that lack electrification, useful within narrow spaces, and low headroom applications. The hoist can be operated by:

- Connecting a power drill directly to the drive mechanism
- Connecting a power drill to the flexible drive shaft
- Using the hand crank directly to the drive mechanism
- Connecting the hand crank handle to the flexible drive shaft
- Standard product is attached with powershaft 5ft, a bit and a handle
- Lifting speed meets the specifications when r.p.m. of cordless driver drill is 1300
- Please apply 15.6V cordless driver drill to EHM-F-38.
- Do not use electric or pneumatic impact driver.



Scan for Webpage,
User & Parts Manual

4 METHODS OF OPERATING THE HOIST



SPECIFICATIONS - POWER HOISTMAN CORDLESS DRILL DRIVEN & HAND CRANK HOIST

| Model | Kind of Cordless Driver Drill | With Powershaft | | Direct Connection | | Standard Lift (ft) | Test Load (lbs) | Headroom (in) | Length of Power Shaft (ft) | Load Chain Dia x Pitch (mm) | Weight w/ Power Shaft (lbs) |
|-----------|-------------------------------|------------------|--------------------------|-------------------|--------------------------|--------------------|-----------------|---------------|----------------------------|-----------------------------|-----------------------------|
| | | Rated Load (lbs) | Lifting Speed (ft / min) | Rated Load (lbs) | Lifting Speed (ft / min) | | | | | | |
| EHMF-12.5 | 12V | 275 | 10 | 275 | 10 | 10 | 125% | 8.7 | 5 | 3.1 x 9.3 | 9 |
| EHMF-20 | 12V | 400 | 6 | 400 | 6 | 10 | 125% | 8.7 | 5 | 3.1 x 9.3 | 9 |
| EHMF-38 | 15.6V | 838 | 5.5 | 838 | 5.5 | 10 | 125% | 10.8 | 5 | 4.3 x 12 | 12 |

EHMF 12.5
Rated load 275 lbs.

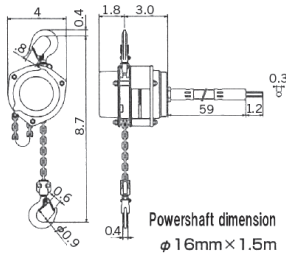

EHMF 20
Rated load 400 lbs.

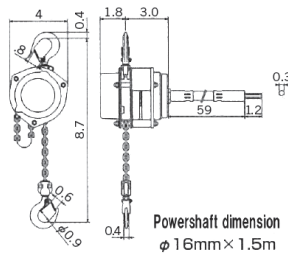

EHMF 38
Rated load 838 lbs.

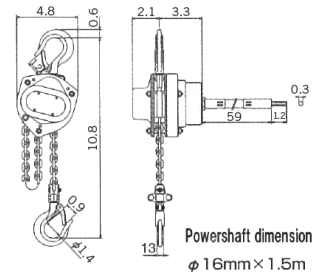

All schematics measured in inches

