

# EXPLODED VIEW AND PARTS NAMES

## ASSEMBLY PARTS

|                            |                           |
|----------------------------|---------------------------|
| ① Top Hook Ass'y           | ⑫ Brake Disc Ass'y        |
| ② Gear Side Plate Ass'y    | ⑬ Power Cord Holder Ass'y |
| ③ Motor Side Plate Ass'y   | ⑭ Cord Holder Ass'y       |
| ④ Motor Case Ass'y         | ⑮ Bottom Hook Ass'y       |
| ⑤ 1st Gear Ass'y           | ⑯ Limit Switch Ass'y      |
| ⑥ Electric Equipment Ass'y | ⑰ Limit Switch Ass'y      |
| ⑦ Load Sheave Ass'y        | ⑱ Holding Metal Ass'y     |
| ⑧ Sheave Cover Ass'y       | ⑲ Pushbutton Ass'y        |
| ⑨ Ratchet Disc Ass'y       | ⑳ Chain Stopper Ass'y     |
| ⑩ Pawl Ass'y               | ㉑ Chain Bag Ass'y         |
| ⑪ Rotor Ass'y              |                           |

When ordering spare parts, be sure to say Model Code, Serial No., Part No. (or Ass'y No.), Part Name, and Quantity. Assembly Parts are sold only in complete assembly set.

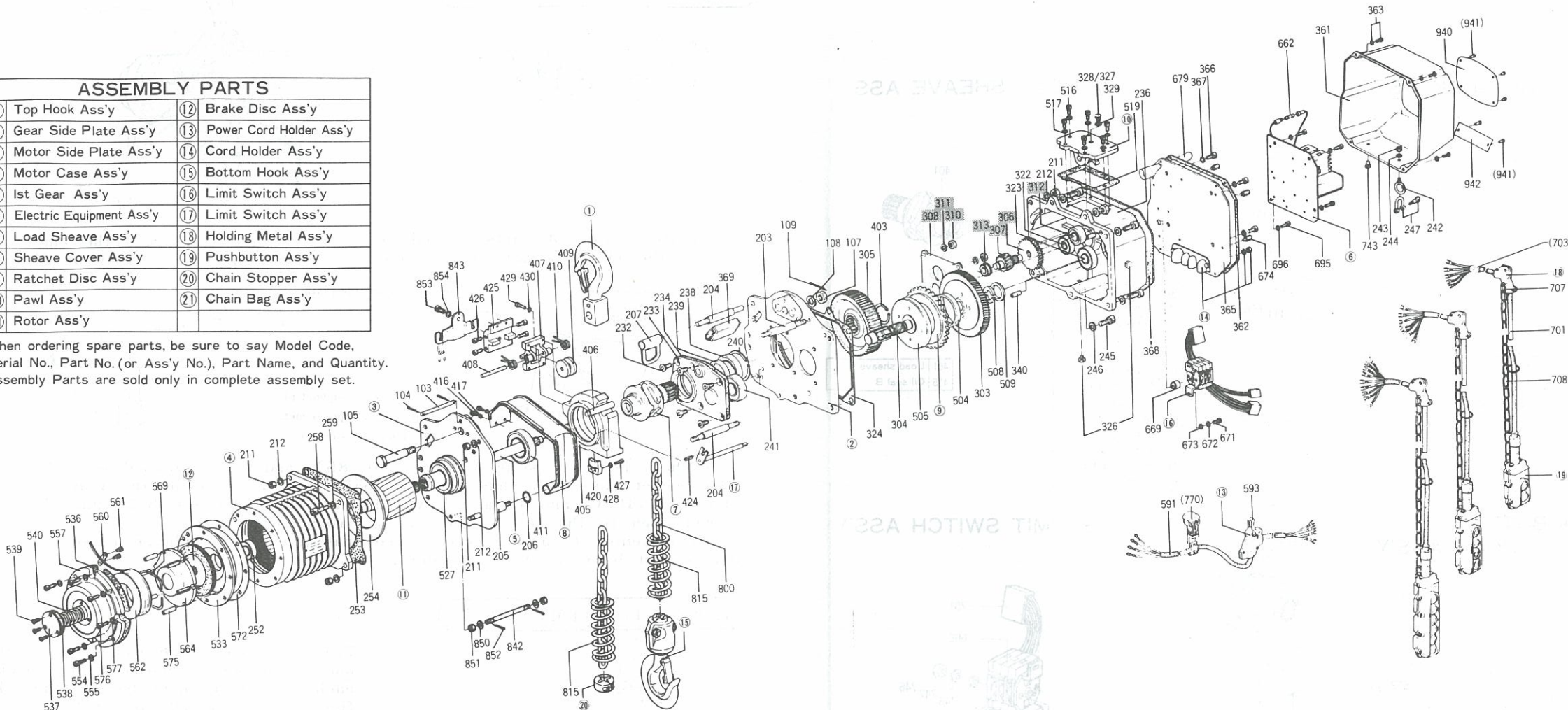

|     |                              |
|-----|------------------------------|
| 103 | Top hook stopper pin         |
| 104 | Cotter pin                   |
| 105 | Top hook pin                 |
| 107 | Hex. nut                     |
| 108 | Spring washer                |
| 109 | Cotter pin                   |
| 203 | Stay bolt (A)                |
| 204 | Stay bolt (B)                |
| 205 | Stay bolt (C)                |
| 206 | O ring                       |
| 207 | Hanger, holding metal        |
| 211 | Hex. nut                     |
| 212 | Spring washer                |
| 232 | Sunk bolt w/hex. hole & seal |
| 233 | Flange B                     |

|     |                     |
|-----|---------------------|
| 234 | Packing, Flange B   |
| 236 | Gear case           |
| 238 | Ball bearing 2      |
| 239 | Oil seal A          |
| 240 | Snap ring           |
| 241 | Ball bearing 3      |
| 242 | Eye bolt            |
| 243 | Hex. nut            |
| 244 | Spring washer       |
| 245 | Bolt w/hex. hole    |
| 246 | Spring washer       |
| 247 | Shackle             |
| 252 | Ball bearing 7      |
| 253 | Packing, Motor case |
| 254 | Plate for locating  |
| 258 | Bolt w/hex. hole    |

|     |                                  |
|-----|----------------------------------|
| 259 | Spring washer                    |
| 303 | DA-2nd gear DB-4th gear          |
| 304 | DA-3rd gear DB-5th gear          |
| 305 | DA-4th gear DB-6th gear          |
| 322 | Ball bearing 4                   |
| 323 | Ball bearing 5                   |
| 324 | Packing, gear case               |
| 326 | Oil plug                         |
| 327 | Oil plug                         |
| 328 | Air-hole bolt                    |
| 329 | Packing, air hole bolt           |
| 340 | Spring pin                       |
| 361 | Electric Component Case          |
| 362 | Packing, electric component case |
| 363 | Hex. bolt w/cross hole & washer  |

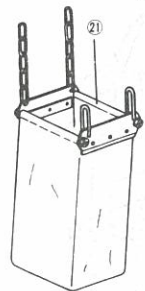

|     |                                |
|-----|--------------------------------|
| 365 | Electric component board       |
| 366 | Bolt w/hex. hole               |
| 367 | Spring washer                  |
| 368 | Adiabatic packing              |
| 369 | Protection rubber of lead wire |
| 403 | Snap ring                      |
| 405 | Chain guide                    |
| 406 | Anti-rotation pin              |
| 407 | Roller board                   |
| 408 | Roller pin                     |
| 409 | Roller                         |
| 410 | Intermediate stick spring      |
| 411 | Ball bearing                   |
| 416 | Bolt w/hex. hole               |
| 417 | spring washer                  |

|     |                          |
|-----|--------------------------|
| 420 | Stripper                 |
| 424 | Corrugated spring pin    |
| 425 | Holding board for spring |
| 426 | Bolt w/hex. hole         |
| 427 | Bolt w/hex. hole         |
| 428 | Spring washer            |
| 429 | Bolt w/hex. hole         |
| 430 | Spring washer            |
| 504 | Bush for ratchet disc    |
| 505 | Disc hub                 |
| 508 | Split ring               |
| 509 | Stopper ring             |
| 516 | Bolt w/hex. hole & seal  |
| 517 | Spring washer            |
| 519 | Packing, pawl board      |

|     |                          |
|-----|--------------------------|
| 527 | Ball bearing 6           |
| 533 | Bearing support          |
| 536 | Packing, brake stator    |
| 537 | Spring cover             |
| 538 | Packing, spring cover    |
| 539 | Bolt w/hex. hole         |
| 540 | Brake spring             |
| 554 | Bolt w/hex. hole         |
| 555 | Spring washer            |
| 557 | Brake stator             |
| 560 | Cord pressing metal      |
| 561 | Bolt w/hex. hole         |
| 562 | Brake coil               |
| 564 | Moving core              |
| 569 | Snap ring                |
| 572 | Packing, bearing support |

|     |                       |
|-----|-----------------------|
| 575 | Corrugated spring pin |
| 576 | Bolt w/hex. hole      |
| 577 | Spring washer         |
| 591 | Cabtyre cord          |
| 593 | Shackle               |
| 662 | Fuse                  |
| 669 | Joint pipe            |
| 671 | Bolt w/hex. hole      |
| 672 | Spring washer         |
| 673 | Plain washer          |
| 674 | Hex. stay pin         |
| 679 | Glass tube            |
| 695 | Bolt w/hex. hole      |
| 696 | Spring washer         |
| 701 | Pushbutton cord       |

|     |                         |
|-----|-------------------------|
| 703 | Bush                    |
| 707 | Shackle                 |
| 708 | Suspension chain        |
| 743 | Plug                    |
| 770 | Cable hanger            |
| 800 | Load chain              |
| 815 | Stopper spring          |
| 842 | Chain bag support pin   |
| 843 | Chain bag support metal |
| 850 | Plain washer            |
| 851 | Hex. nut                |
| 852 | Cotter pin              |
| 853 | Bolt w/hex. hole        |
| 854 | Spring washer           |

|                   |                  |
|-------------------|------------------|
| 940               | Nameplate        |
| 941               | Rivet            |
| 942               | Nameplate (Type) |
| PARTS FOR DB-TYPE |                  |
| 306               | 2nd gear         |
| 307               | 3rd gear         |
| 310               | Hex. nut         |
| 311               | Spring washer    |
| 308               | Center plate     |
| 312               | Ball bearing 10  |
| 313               | Ball bearing 11  |