

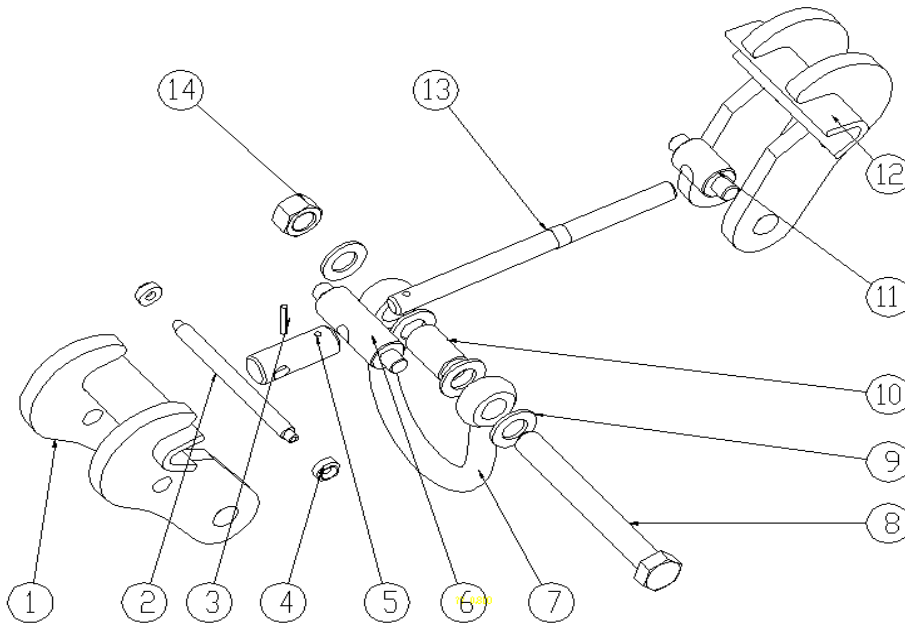

## Parts List for JBC Beam Clamp



**• SEE NOTES BELOW WHEN ORDERING PARTS**

Part No.	Part Name	Quantity
JBC-P1	Side Plate Assembly	1
JBC-P2	Handle Assembly	1
JBC-P3	Spring Pin	1
JBC-P4	handle End stop	2
JBC-P5	Link Bush	1
JBC-P6	Left Adjust Set	1
JBC-7	Flying Ring	1
JBC-P8	M20 Load Bar	1
JBC-P9	Washer	4
JBC-P10	Bush	1
JBC-P11	Right Adjust Set	1
JBC-P12	Nipper Jaw	2
JBC-P13	Adjust Pin	1
JBC-P14	M20 Self-lock Nut	1

- When ordering parts, use the series, model, and part number i.e. **JBC-10-P1** would be used when ordering the side plate assembly for a 10 ton beam clamp

**Elephant Lifting Products**  
 2718 South Ruby Street, Suite B  
 Gonzales, LA 70737 USA  
 Phone: 225-644-6113 Fax: 225-644-6695  
[www.elephantlifting.com](http://www.elephantlifting.com)